

FOR LEASE

11088 OLSON DRIVE, RANCHO CORDOVA, CA

1,445+- SF TO 5,524+- SF RETAIL / OFFICE SPACE AVAILABLE



BOULDIN & ENGLISH
COMMERCIAL REAL ESTATE

Exclusive Agents

10411 Old Placerville Road, Suite #215,
Sacramento, California 95827

Contact:

BILL F. BOULDIN / GLENN L. ENGLISH
bbouldin@boueng.com / genglish@boueng.com
DRE Lic: 00812209 / DRE Lic: 00840864

(916) 361-8000

The information contained herein has either been given to us by the owner of the property or obtained from sources we deem reliable. We have no reason to doubt its accuracy, but we do not guarantee it. Prospective Buyers should carefully verify the items of information contained herein.

11088 OLSON DRIVE, RANCHO CORDOVA, CA

Property Details:

11088 Olson Drive, Rancho Cordova, CA

11,044 +/- SF Retail / Office Building

- Street Corner / Frontage location
- Located at SEC of Olson Drive and Progress Court
- 1,445+- SF to 5,524+- Contiguous SF Available
- Located directly across the street from the U.S. Post Office
- Located adjacent to River City Church
- Easy access to U.S. 50 via Zinfandel Drive or Sunrise Boulevard
- Available Spaces:
 - Suite B: 1,453+- SF
 - Suite C: 2,421+- SF
 - Suite D: 1,650+- SF
- Can combine spaces for occupancy up to 5,524+- contiguous SF

Rent Rates from 1.65 to \$1.80/SF/Mo., NNN



11088 OLSON DRIVE, RANCHO CORDOVA, CA

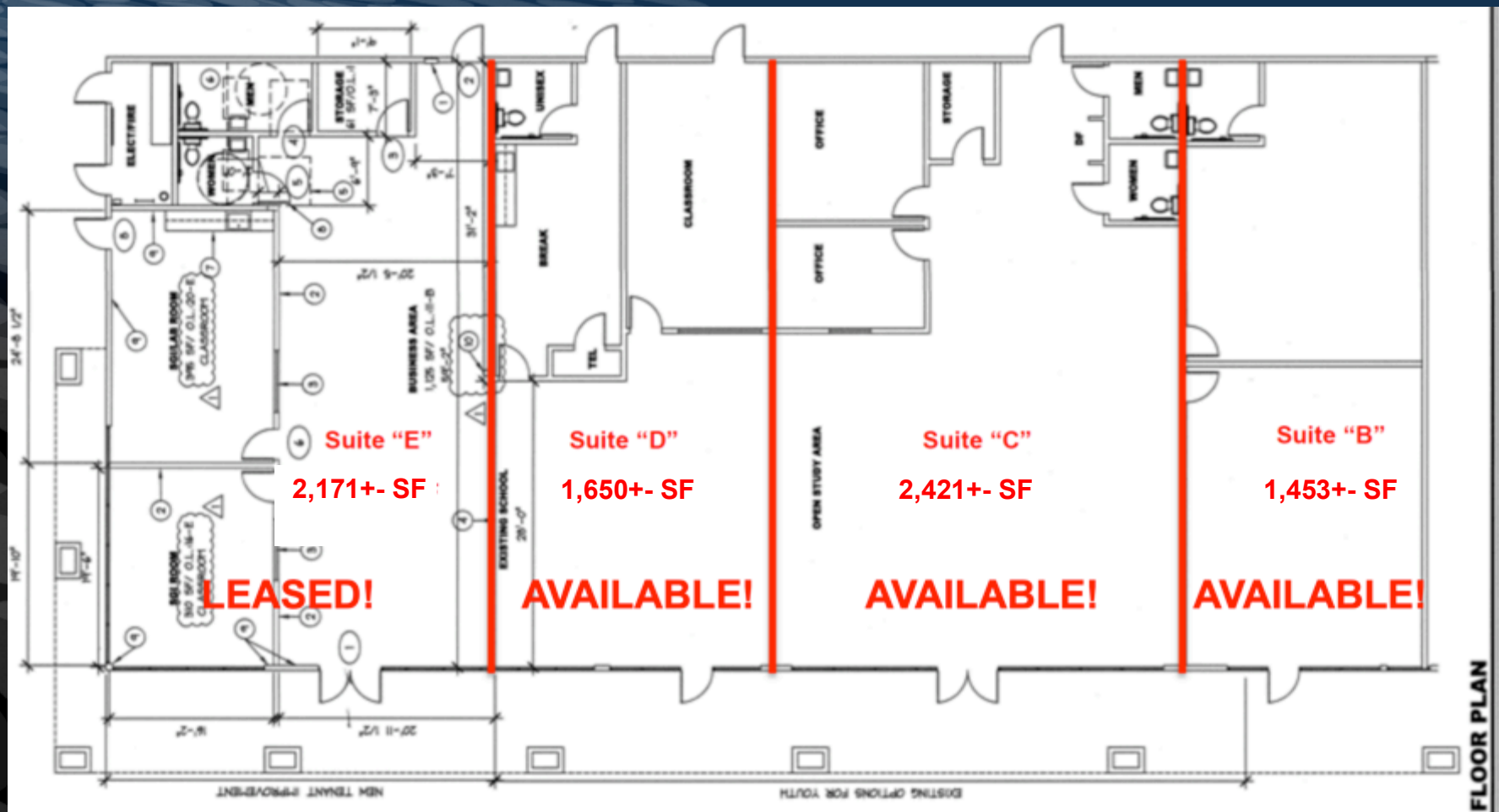

11088 OLSON DRIVE, RANCHO CORDOVA, CA

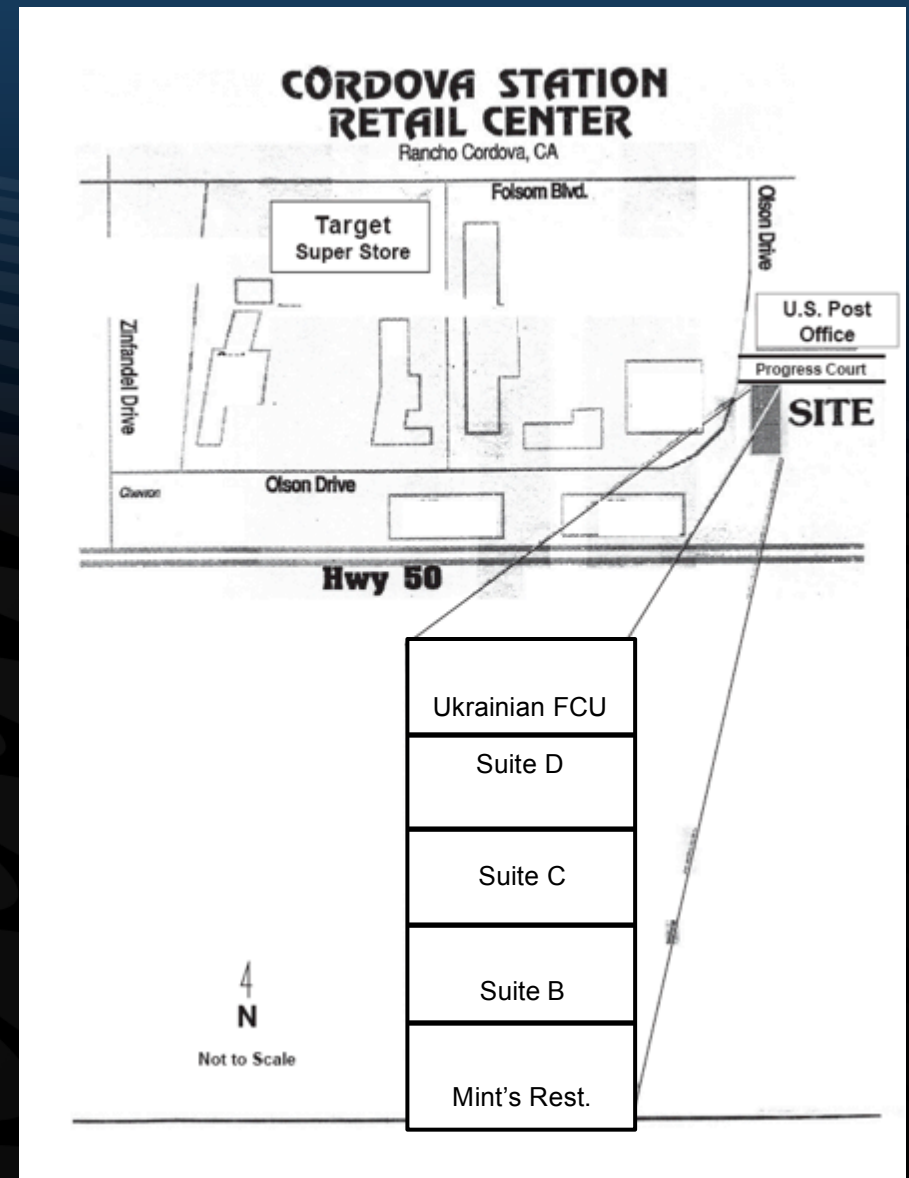
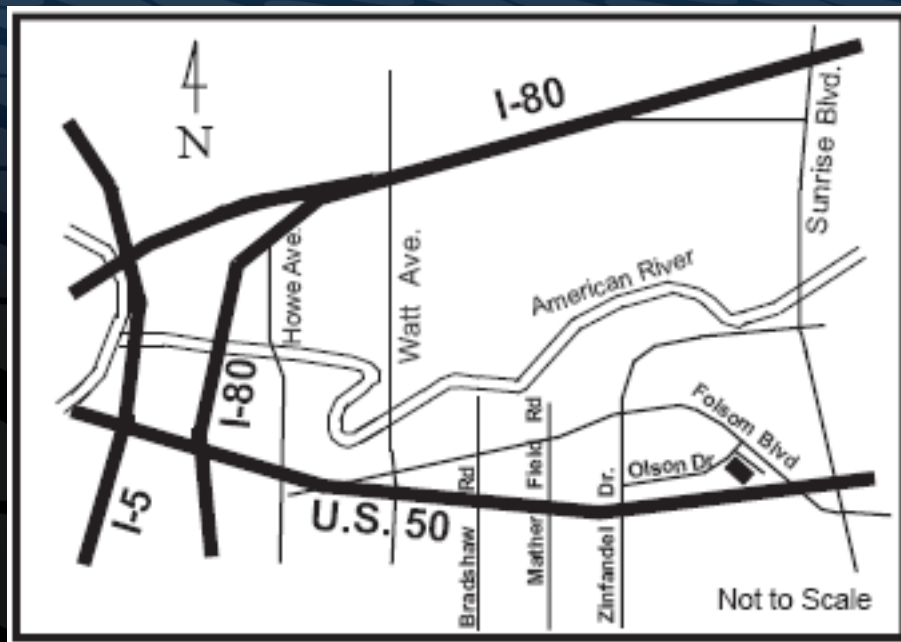

11088 OLSON DRIVE, RANCHO CORDOVA, CA

